





.....	<b>1</b>
.....	1
.....	1
.....	2
.....	<b>3</b>
.....	3
.....	4
.....	4
.....	5
.....	<b>5</b>
.....	5
.....	6
.....	9
.....	<b>9</b>
.....	10
.....	10
.....	10
.....	<b>11</b>
.....	11
.....	16
.....	<b>17</b>

.....	19
.....	19
.....	<b>19</b>
.....	19
.....	19
.....	19
.....	<b>20</b>
.....	20
.....	21
.....	21
.....	<b>22</b>
.....	22
.....	24
.....	24
.....	25
.....	<b>25</b>

1.

1		1 2 3 4 5
2		6 7 8 9 10 11 12 13 14 BIM 15

		16 17 18
3		19 20 21 22 23 24  25 26 27

2.

3.

1.

2.

3.

4.

5.



1.

2.

3.

4.

5.

1.

2.

3.

4.

5.

6.

7.

8.

9.



10.

11.

1.

1	60	100			
2					
3					40
40	20	20		20	40
4					

GBT 51231-2016

JGJ 1-2014

GB 50666-2011

JGJ 276-2012

DBJ61/T118-2016

DBJ/T 61-124-2016

GB 50204-2015

JGJ 355-2015

16G906

18G901-1

22G101-1

15G107-1

G310-1 2

15G365-1

15G365-2

60mm

15G366-1

15G368-1

20G367-2

15J939-1

5

2.

1

3

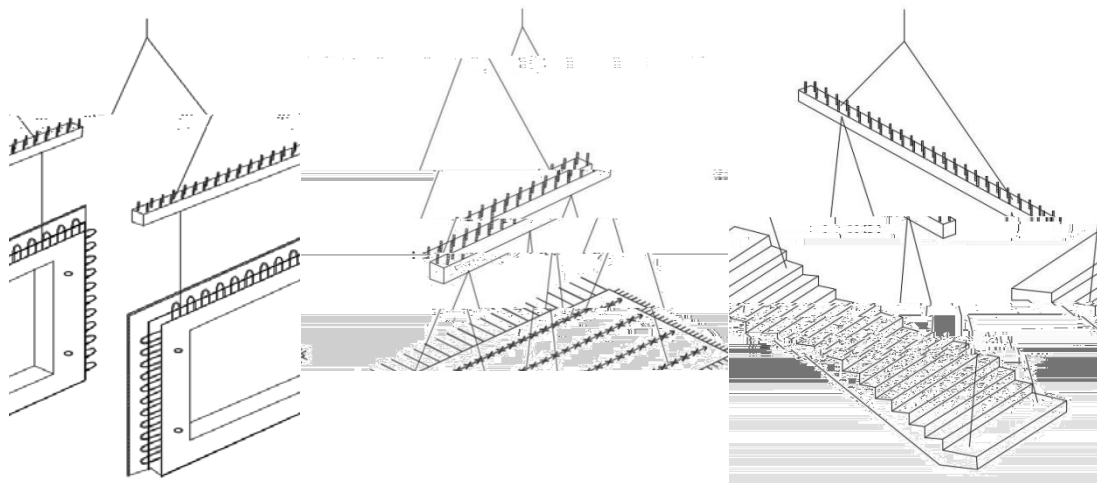

2

PC

3

120

4

5

6

4

4

3

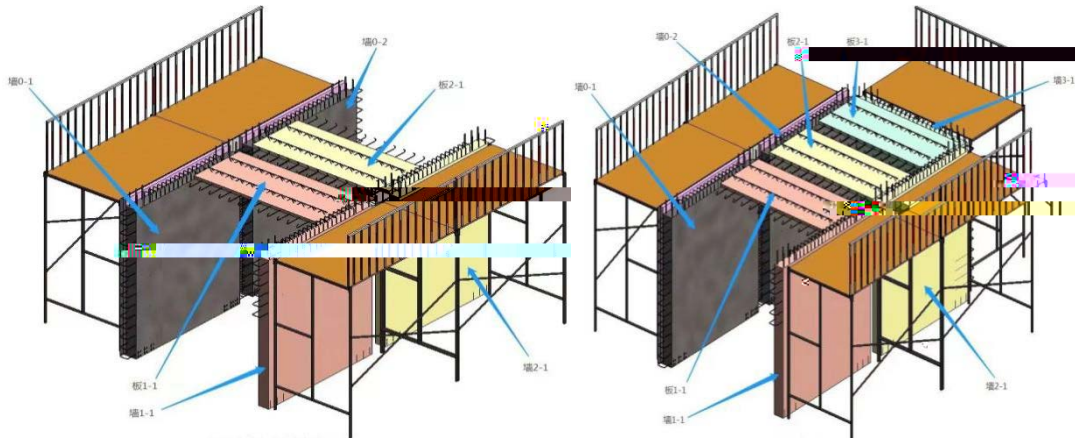

2

3

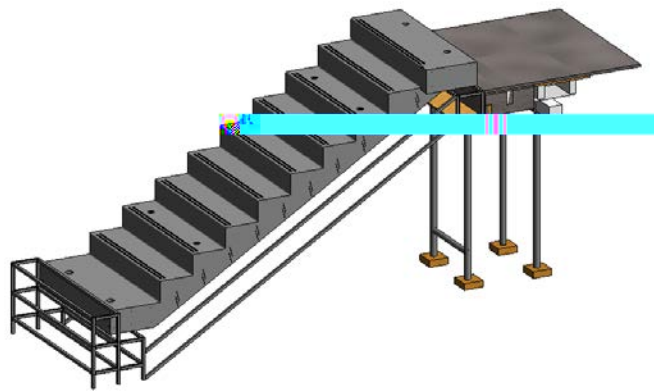

9 24 ~9 26

9 24

9 25

9 26

100

3

100

0.5 0.3 0.2

1.

2.

3 :7

3.

1

3

3

=  $\times 30\% + 1 + 2 +$

3  $/3 \times 70\%$

4.

1-1

1-2

**1-1**

1			25		
2			25		
3			25		
4			25		

**1-2**

1—					
1	10	2	1	2	
		2		2	

			2	2		
			1	2		
				2		
2	10			2		
		1		2		
				2		
		1		2		
			1	2		
				2		
			1	2		

1mm 1 5mm 3

3 15



		50mm	3		
			3		
			2		
			2		-
		2	3		
			2		
5	10	2	4		
			2		
			2		-
			2		-
6	15	1mm	5		-
		1			
		1mm	1	5	-
		±3mm	±1mm	1	5
					-
7	20	t 30	20		
		35	18		
		40	15		
		50	12		
			9		
2—					
1	5		2		
		2			

			3		
2	10		2		
		1	2		
			2		
			2		
			2		
3	10		4		
		1mm 1	4		
			2		
4	15		4		
			5		
			3		
		1	3		
5	20	1m 30s	5		
		500mm	5		
			5		

		28	15		
		33	12		
			9		
3—					

1

1

5

			4		
			5		
		PE	4		
			-		
5	20	1mm	7		-
		±5mm	6		-
		±1mm 1	7		-
6	20	±3mm ±1mm 1	7		-
		t 12	20		
		17	18		
		22	15		
		27	12		

4

5

6

7

2.

1-3

1-4

**1-3**

					4	4		
				1	4	4		
				1	4	4		
			-					

		5t		1	20	22	
		5t		1	12	14	
		5t		1	4	5	
		/		3	36	200	20 40 140
				3	36	40	
		/		3	36	40	20 40
		/		3	36	40	

**1-4**

		25t		1	4	4	
				1	4	4	
				1	4	4	2 4 2
				1	4	4	
				2	40	45	
				2	40	45	
				4	48	53	
				2	24	30	
				4	48	55	

3

				1	4	6		
				1	12	16		
				1	4	6		
				1	4	6		
				1	4	6		

1-5

1-5

				1	
				1	
				1	
		5m		1	
		2m		1	
				1	

4

4

3

1.

2.

3.

4.

1.

2.

3.

1

2

3



1.

2.

3.

4.

5.

6.

1.

2.

3.

1.

2.

3.

1.

1

3030

2

3

2.

3.

4.

4

5.

6.

7.

8.

1

9 24 ~9 26 9 24 9 25

9 26

2

2

9.

1.

2.

3.

30

20

4.

5.

6.

7.

8.

9.

10.

1.

2.

3.

4.

5.